

1) Screw in small rod into large rod.



2) Drop large ball through both rods until it rests on the brass collar.



3) Drop the W/E portion through the rods until it rests on the large ball.



4) Drop the N/S portion until it interlocks with the W/E portion.



5) Drop the small ball until it rests on top of the large rod.

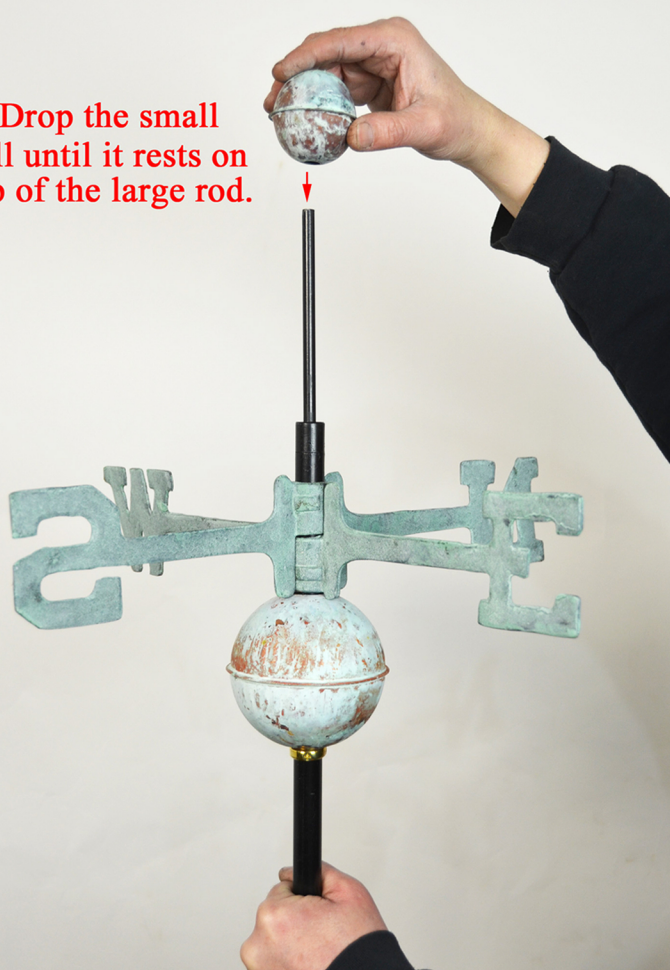

6) Place the angel by dropping it down the small rod and through the small ball.



7) You may need to adjust the bottom portion of the weather vane. With a Phillips screwdriver, loosen the brass collar and with it, lift the large ball and the N/S & W/E part of the vane until it touches the bottom of the small ball.

Place the collar to the desired height then tighten the screw.

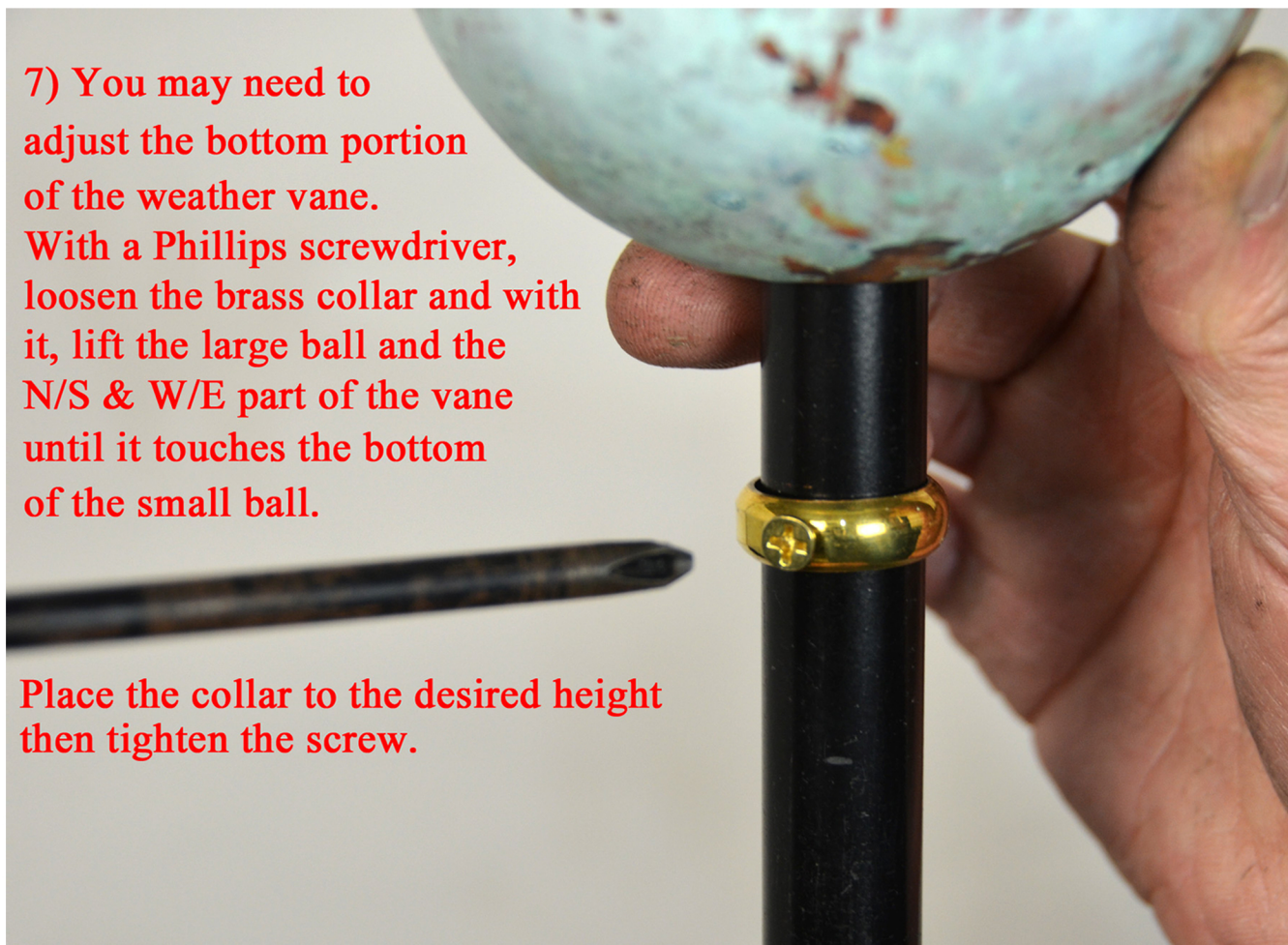

8) Tighten the N/S & W/E portions to the large rod with the brass set screws.



The final assembled product should look something like this...

